



**BLOCKS**

**STEEL SHELL SNATCH BLOCK - 2, 4 & 8 TON**



SWIVEL SHACKLE (SS)

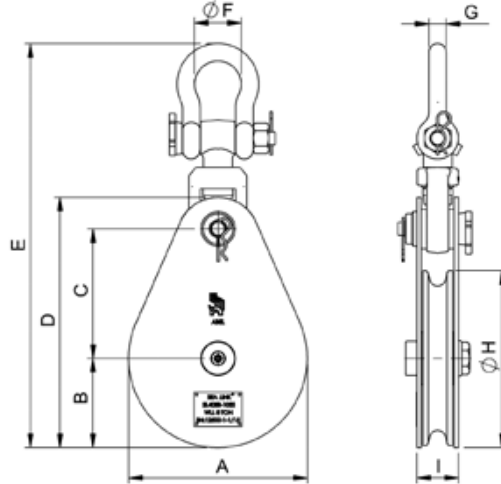

TAILBOARD (TB)



SWIVEL HOOK (SH)



TOP DEAD END (TDE)

MODEL NO.	WLL TN	WIRE ROPE ØR	DIMENSIONS (MM)									WEIGHT (LBS)		
			A	B	C	D	E	ØF	G	ØH	I	SS	SH	TB
												SWIVEL SHACKLE	SWIVEL HOOK	TAILBOARD
SL402B-3	2	5/16 - 3/8	3.0	1.5	2.7	5	9.5	1.3	0.5	3	1.4	5	5	
SL404B-4.5	4	3/8 - 1/2	4.6	2.3	4.2	7.6	13.5	1.9	0.7	4.5	1.9	13	13	
SL408B-6	8	5/8 - 3/4	6	3	5.1	9.9	18.8	2.7	1	6	2.3	30	33	18
SL408B-8	8	5/8 - 3/4	8	4	6.3	12	20.9	2.7	1	8	2.4	39	42	28
SL408B-10	8	5/8 - 3/4	10.2	5.1	7.4	14.4	23.3	2.7	1	10	2.4	46	49	34
SL408B-12	8	5/8 - 3/4	12.0	6	9.2	17	25.9	2.7	1	12	2.4	58	61	47

- Blocks built to 4:1 Design Factor.
  - Available with these top fittings - Swivel Hook (SH), Swivel Shackle (SS), Tailboard (TB) and Top Dead End (TDE).
  - Available with Bronze Bushing (B).
  - All accessories are forged.
  - Products are manufactured under the Standard ASME B30.26
  - Dimensions shown represent current models and are subject to change.
  - Blocks shown are standard models.
  - Custom models available upon request.
- See our warnings & application instructions



P. O. Box 596 (90748) • 910 Mahar Ave., Wilmington, CA 90744  
 (800) 322-3131 • (310) 522-9698 • Fax: (310) 522-1043  
 E-Mail: sales@watermansupply.com  
 www.watermansupply.com  
 TradeNet ID 61935