

## CHAIN SHACKLES – Carbon Steel

- All shackle pins are forged from alloy steel, heat treated and tempered to give greater strength.
- All shackles are marked with size (inches and millimeters) and Working Load Limit in tons.
- Ultimate strength equals 5 times Working Load Limit.  
Proof load equals 2.2 times Working Load Limit.
- These shackles meet requirements of Federal Specification RR-C-271D Amendment 1.
- Galvanized per ASTM A153.
- All bolt, nut & cotter shackles have thread protected ends.



Screw Pin Type



Round Pin Type



Bolt &amp; Nut Type

Size (in.)	Working Load Limit* (tons <sup>†</sup> )	Product Code	Product Code	Product Code
1/4	1/2	MC746G	MC546G	MC946G
5/16	3/4	MC747G	MC547G	MC947G
3/8	1	MC748G	MC548G	MC948G
7/16	1-1/2	MC749G	MC549G	MC949G
1/2	2	MC750G	MC550G	MC950G
5/8	3-1/4	MC751G	MC551G	MC951G
3/4	4-3/4	MC752G	MC552G	MC952G
7/8	6-1/2	MC753G	MC553G	MC953G
1	8-1/2	MC754G	MC554G	MC954G
1-1/8	9-1/2	MC755G	MC555G	MC955G
1-1/4	12	MC756G	MC556G	MC956G
1-3/8	13-1/2	MC766G	MC566G	MC966G
1-1/2	17	MC757G	MC557G	MC957G
1-5/8	20	MC785G	MC585G	MC985G
1-3/4	25	MC777G	MC577G	MC977G
2	35	M758G	M558G	M958G

<sup>†</sup>Ton = 2,000 lbs.

Dimensions (inches) apply to all styles of chain shackles

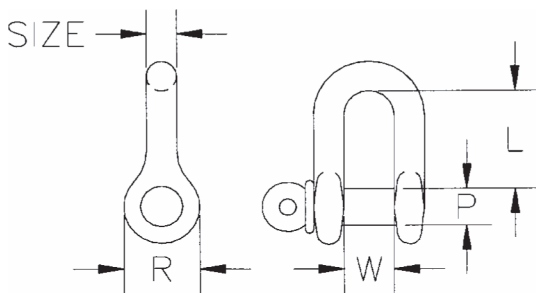

Size	Dia. of Pin P	Width Between Eyes W	Inside Length L	Outside Dia. of Eye R (max.)	Approx. Weight Each (lbs.)
1/4	5/16	15/32	1-1/8	7/8	.12
5/16	3/8	17/32	1-1/4	1	.20
3/8	7/16	21/32	1-7/16	1-1/8	.30
7/16	1/2	3/4	1-11/16	1-1/4	.50
1/2	5/8	13/16	1-7/8	1-3/8	.75
5/8	3/4	1-1/16	2-3/8	1-7/8	1.3
3/4	7/8	1-1/4	2-13/16	2-1/8	2.3
7/8	1	1-7/16	3-5/16	2-3/8	3.5
1	1-1/8	1-11/16	3-3/4	2-5/8	5.0
1-1/8	1-1/4	1-13/16	4-1/4	2-7/8	7.0
1-1/4	1-3/8	2-1/32	4-11/16	3-1/4	9.5
1-3/8	1-1/2	2-1/4	5-1/4	3-1/2	12.5
1-1/2	1-5/8	2-3/8	5-3/4	3-3/4	17.2
1-5/8	1-3/4	2-5/8	6-1/4	4-1/8	23.5
1-3/4	2	2-7/8	7	4-1/2	27.7
2	2-1/4	3-1/4	7-3/4	5-1/4	39.0

\* To avoid injury, do not exceed Working Load Limit.



**WASHINGTON CHAIN & SUPPLY, INC.**

P.O. Box 3645 • 2901 Utah Avenue South • Seattle, WA 98124

Tel: 800-851-3429 • Fax: 206-621-9834 • E-mail: info@wachain.com

Visit our web site for more information: [www.wachain.com](http://www.wachain.com)

