

EATON CROUSE-HINDS PAULUHN

VAPOR & WATERTIGHT INCANDESCENT LIGHTING FIXTURES

CONSTRUCTION: Cast brass or copper-free aluminum with stainless steel hardware. Guard of same material is provided as standard, except when polycarbonate globes are requested.

APPROVALS: UL 1598 (Marine Outside Type Saltwater), ABS, and conforms to IP66.

OUTLETS: All units are supplied drilled and tapped with one 1/2" N.P.T. outlet as standard. (for 723 and 733): Other drilling and tapping options up to a maximum of 3/4" N.P.T. four way available. (for 767/768): A 3/4" N.P.T. drilled outlet is available as an option.

LAMP HOLDERS: A phenolic lampholder with nickel plated copper screw shell is supplied as standard. For porcelain lampholder, add suffix -P to part numbers below. For shockproof lampholder, add suffix -SP to part number.

GLOBE: A clear glass globe is supplied as standard for the 6" for 100W luminaires and 7" for 150W. To order the following options, add the appropriate suffix to the part number below.

Polycarbonate (for 100W only; guard not provided): -PG
Frosted: -FST, Heat Resistant Clear Glass: -HR, Red: -RED, Blue: -BLU, Green: -GRN, Yellow: -YEL

REFLECTOR: (for 767/768 only): The 100W and 150W shallow dome reflectors are fiberglass reinforced polyester. All others are made from ABS. For shallow dome reflector, add suffix -L to part number below. For 30° angle dome reflector, add suffix -N to part number.



723



733



767/768

GASKET: One-piece silicone gasket provides a watertight seal between the lens and housing.

VOLTAGE: Rated up to 300V AC.

LAMPS: Supplied without lamps.

TERMINAL BLOCK: (723 only): A four pole or six pole terminal block is available as an option. To order four pole block, add suffix -T to part number below; to order six pole block, add suffix -T6 to part number.

DOUBLE POLE TOGGLE SWITCH: (for 723 and 733): with watertight boot is available as an option. To order, add suffix -K to part number below.

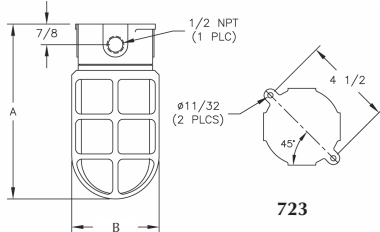

723

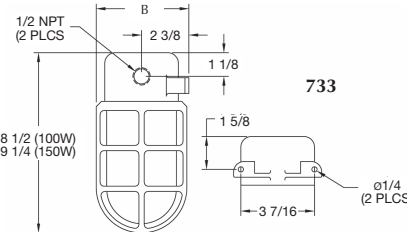

733

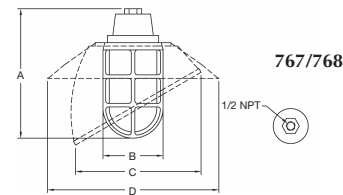

767/768

Description	Lamp Size	Brass Wt. (lbs.)	Brass (B)	Aluminum (A)	Dimensions (in.)			
					A	B	C Option N	D Option L
Mounting								
Ceiling	100W max	6.4	723B	723A	9-1/8	4-1/4		
Ceiling	150W max	6.7	723B7	723A7	9-7/8	4-1/4		
Wall	100W max A-19	5.0	733B	733A	8-1/2	4-1/2		
Wall	150W max A-21	5.0	733B7	733A7	9-1/4	4-1/2		
Pendant	100W max	4.0	767B	767A	8-3/4	4-1/4	9-1/4	12-1/2
Pendant	150W max	4.0	767B7	767A7	9-1/2	4-1/4	9-1/4	12-1/2
Pendant	200W max	7.3	768B8	768A8	11	5-3/8	10-3/4	15-3/4
Pendant	300W max	7.3	768B	768A	11-7/8	6	10-3/4	15-3/4

WATERTIGHT PIT OR CARGO HOLD FIXTURES



1440ANS



1449A

CONSTRUCTION: Cast brass or copper-free aluminum. Stainless steel hardware.

GLOBE: Clear impact resistant glass globe is standard.

APPROVALS: UL 1598A (Marine Outside Type Saltwater), ABS, and conforms to IP66.

OUTLETS: Furnished blank unless otherwise specified. Max. 3/4" N.P.T. fourway.

REFLECTOR: Spun aluminum with a white high gloss, polyester powder coating.

GUARD: Heavy-duty casting, hinged to the unit.

TERMINAL BLOCK: A four pole terminal block is standard. (CX3070)

LAMP HOLDER: Phenolic medium base supplied as standard.

LAMPS: All luminaires supplied without lamps.

* NOTE: Designed for severe and arduous environments.

Description	Lamp Size	Marine Brass Weight (lbs.)	Marine Brass Type (B)	Aluminum Type (A)	Dimensions	
					Ø	H
Junior Cargo Hold Unit	100W max A-19	13.0	1440B	1440A	9-5/8"	5"
North Sea Cargo Hold Unit*	100W max A-19	14.5	1440BNS	1440ANS	9-5/8"	5"
Standard Cargo Hold Unit	200W max	19.0	1449B	1449A	12-3/4"	6"