

EATON CROUSE-HINDS PAULUHN

WATERTIGHT & VAPORPROOF FLUORESCENT FIXTURES FOR HAZARDOUS LOCATIONS

U.L. 1598A, 844 NEMA 4X & 7 U.S.C.G. IP67 ABS
Class I Division 2 Groups A, B, C & D

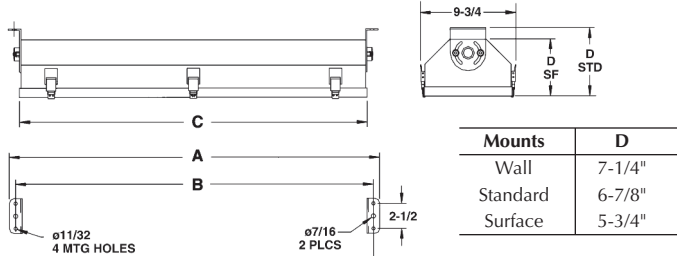

| Cat. No. | A | B | C |
|----------|---------|---------|---------|
| APA 2 | 31-1/2" | 30-1/4" | 29-1/4" |
| APA 4 | 55-1/2" | 54-1/4" | 53-1/4" |

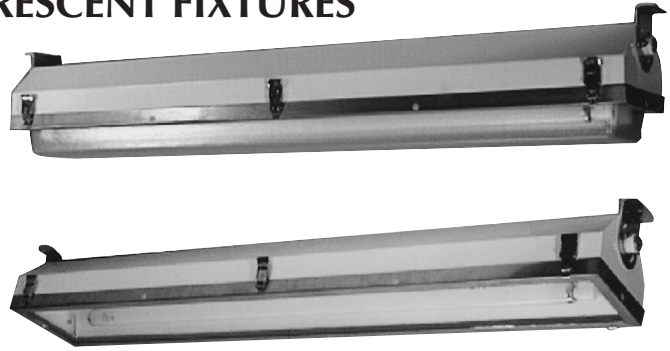

CONSTRUCTION: The lens frame and latches are made of stainless steel. The housing and mounts are available in 316 stainless steel, natural finish for a completely stainless steel fixture. The aluminum fixture has a polyester powder coated housing with mounting fittings in natural aluminum.

BALLAST: High power factor electronic ballasts supplied for 120-277 VAC 50/60 Hz applications. Ballasts are rated to 55°C maximum ambient temperature.

FEATURES: The unit is provided with positive-locking spring loaded stainless steel latches for a tight seal between the stainless steel frame and the housing. The standard adjustable brackets allow a 110° range of mounting positions.

REFLECTOR: White powder coated aluminum.

LAMP TYPE: Fluorescent lamps standard, compact fluorescent optional. Available in one, two or three lamps.

LENS: High impact resistant, drop lens acrylic for FWN series. Polycarbonate flat lens for FWFN series.

OUTLETS: The units are provided with two 3/4" N.P.T. and one plug, allowing for thru-feed service where necessary.

GASKETS: One continuous piece extruded black neoprene gasket which provides an effective seal between the lens and the housing, greatly reducing light loss and outside contamination by bugs, dirt and moisture.

OPTIONS: The factory installed options listed below are available by adding the following suffix to the catalog number: /316 for 316 grade stainless steel, SM for shock mount, SF for surface mount, LL for wall mount, PT for pendant mount, TG for tempered glass (FWFN), X for polycarbonate drop lens, EM for emergency ballast (1 lamp), EM2 for emergency ballast (2 lamps), F for fused ballast, 226 for 220V 60 Hz, 276 for 277V 60 Hz, 225 for 220V 50 Hz, 12 for 12VDC, 24 for 24VDC, 48 for 48VDC.

- For emergency lighting applications below 0°C, the fixture is factory modified to protect Ni-Cad batteries and emergency lamps from temperatures down to -29°C.
- Beam clamp mounting kit consists of a beam clamp, a S.S. safety cable and a cord connector. To order, add suffix "BC" to catalog number. To order the individual components, use part number shown.

| Description | No. of Lamps | Lamp Type | Catalog No. | |
|------------------------------------|--------------|-----------|-------------|-----------------|
| | | | Aluminum | Stainless Steel |
| 2 ft. 17W T8 Linear Fluorescent | 1 | F17 | APA21170 | APS21170 |
| 2 ft. 17W T8 Linear Fluorescent | 2 | F17 | APA22170 | APS22170 |
| 2 ft. 17W T8 Linear Fluorescent | 3 | F17 | APA22170 | APS22170 |
| 2 ft. 35W T12HO Linear Fluorescent | 1 | F24 | APA21870 | APS21870 |
| 2 ft. 35W T12HO Linear Fluorescent | 2 | F24 | APA22870 | APS22870 |
| 2 ft. 40W Compact Fluorescent | 1 | FT40 | APA21270 | APS21270 |
| 2 ft. 40W Compact Fluorescent | 2 | FT40 | APA22270 | APS22270 |
| 2 ft. 40W Compact Fluorescent | 4 | FT40 | APA22470 | APS22470 |
| 2 ft. 14W T5 Linear Fluorescent | 1 | F14 | APA21670 | APS21670 |
| 2 ft. 14W T5 Linear Fluorescent | 2 | F14 | APA22670 | APS22670 |
| 2 ft. 14W T5 Linear Fluorescent | 3 | F14 | APA23670 | APS23670 |
| 2 ft. 24W T5HO Linear Fluorescent | 1 | F24 | APA21570 | APS21570 |
| 2 ft. 24W T5HO Linear Fluorescent | 2 | F24 | APA22570 | APS22570 |
| 2 ft. 24W T5HO Linear Fluorescent | 3 | F24 | APA23570 | APS23570 |
| | | | | |
| 4 ft. 32W T8 Linear Fluorescent | 1 | F32 | APA41170 | APS41170 |
| 4 ft. 32W T8 Linear Fluorescent | 2 | F32 | APA42170 | APS42170 |
| 4 ft. 32W T8 Linear Fluorescent | 3 | F32 | APA42170 | APS42170 |
| 4 ft. 60W T12HO Linear Fluorescent | 1 | F48 | APA41870 | APS41870 |
| 4 ft. 60W T12HO Linear Fluorescent | 2 | F48 | APA42870 | APS42870 |
| 4 ft. 40W Compact Fluorescent | 1 | FT40 | APA41270 | APS41270 |
| 4 ft. 40W Compact Fluorescent | 2 | FT40 | APA42270 | APS42270 |
| 4 ft. 40W Compact Fluorescent | 4 | FT40 | APA42470 | APS42470 |
| 4 ft. 28W T5 Linear Fluorescent | 1 | F28 | APA41670 | APS41670 |
| 4 ft. 28W T5 Linear Fluorescent | 2 | F28 | APA42670 | APS42670 |
| 4 ft. 28W T5 Linear Fluorescent | 3 | F28 | APA43670 | APS43670 |
| 4 ft. 54W T5HO Linear Fluorescent | 1 | F54 | APA41570 | APS41570 |
| 4 ft. 54W T5HO Linear Fluorescent | 2 | F54 | APA42570 | APS42570 |
| 4 ft. 54W T5HO Linear Fluorescent | 3 | F54 | APA43570 | APS43570 |