

## VIKING LIFE-SAVING EQUIPMENT, INC.

### Norsafe - Hooks, Daughter Craft, Work Boats

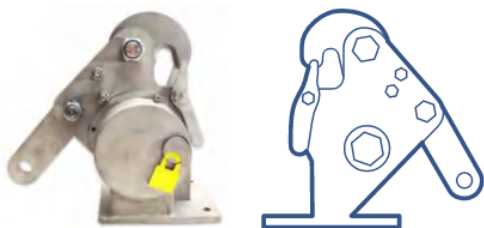

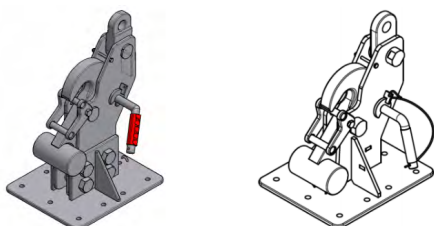

TOR MK2 Hooks	
Item No.	SWL (tonnes)
TOR MK2 3.36T	3.36
TOR MK2 5T	5
TOR MK2 8T	8
TOR MK2 14T	14
TOR MK2-S 3.36T	3.36
TOR MK2-S 6T	6
TOR MK2-S 9T	9
TOR MK2-S 12T	12



K4-D Hooks	
Item No.	SWL (tonnes)
K4-D	4
K4-D-FM	4



Daughter Craft					
Item No.	No. of persons	Boat weight plus equipment (kg)	L x B x H (m)	Davit load with persons (kg)	Diagram
MUNIN 1000	24	5,700	10.60 x 3.51 x 3.75	7,680	
MUNIN 1200	24	7,500	11.95 x 3.51 x 3.75	9,480	
Engine type: Inboard diesel					



Work Boat					
Item No.	No. of persons	Boat weight plus equipment (kg)	L x B x H (m)	Engine type	Diagram
MUNIN 980 WB	10	7,700	10.20 x 3.60 x 4.20	Inboard Diesel	



# VIKING NORSAFE

270 Certified Servicing Stations worldwide  
– see [www.VIKING-life.com](http://www.VIKING-life.com)

**VIKING Norsafe**  
668 Distributors Row, Suite D, New Orleans, LA 70123 USA

Tel: +1 504 733 0100 | TradeNet ID 52643