



**LBNO
SPELTER SOCKETS - GALVANIZED**

Designed to fit the rope properly and to develop the full strength of the wire rope, LBNO Sockets have grooves in the socket basket for superior strength and holding power when pouring with zinc. LBNO Sockets comply with both Federal and International Standards to allow for use with resin pour.



LB-304

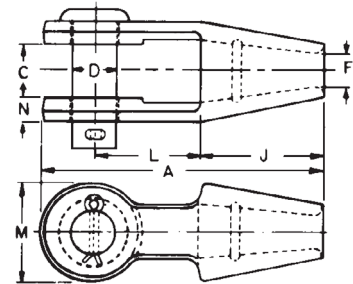

OPEN SPELTER SOCKETS STANDARD-GALVANIZED		CAST STEEL HEAT TREATED							
Wire Rope Diameter Inches	DIMENSION IN INCHES								Weight Pounds Each
	A	C	D	F	J	L	M	N	
1-1/2	15-1/8	3	2-3/4	1-5/8	6	6-3/8	5-3/8	1-3/16	42.5
1-5/8	16-1/4	3	3	1-3/4	6-1/2	6-1/2	5-3/4	1-5/16	57
1-3/4-1-7/8	18-1/4	3-1/2	3-1/2	2	7-1/2	7	6-1/2	1-9/16	81-1/2
2-2-1/8	21-1/2	4	3-3/4	2-1/4	8-1/2	9	9	1-13/16	114
2-1/4-2-3/8	23-1/2	4-1/2	4-1/4	2-1/2	9	10	7-3/4	2-1/8	162
2-1/2-2-5/8	25-1/2	5	4-3/4	2-7/8	9-3/4	10-3/4	8-1/2	2-3/8	228
2-3/4-2-7/8	27-1/2	5-1/2	5	3-3/16	11	16-1/4	9	3-1/4	338
3-3-1/8	29	5-3/4	5-1/4	3-5/8	12	11-1/4	9-1/2	3	365
3-1/2-3-5/8	33-1/4	6-3/4	6	3-7/8	14	12-1/2	10-3/4	3-1/4	546
3-3/4-4	36-1/4	7-1/2	7	4-1/4	15	13-1/2	12-1/2	3-1/2	729
4-1/2	44-7/8	9-1/4	8-1/2	4-7/8	18-1/2	16-3/4	15-1/2	4-3/8	1550

CLOSED SPELTER SOCKETS STANDARD-GALVANIZED		CAST ALLOY STEEL HEAT TREATED							
Wire Rope Diameter Inches	DIMENSION IN INCHES								Weight Pounds Each
	A	B	C	D	F	J	K	L	
1-1/2	14-1/8	2	5-3/8	3-1/8	1-5/8	6	2-1/2	6-1/8	29
1-5/8	15-3/4	2-1/8	5-3/4	3-1/4	1-3/4	6-1/2	2-3/4	6-3/4	39-1/2
1-3/4-1-7/8	17-1/2	2-3/16	6-3/4	3-17/32	2	7-1/2	3	7-13/16	56-1/2
2-2-1/8	19-3/4	2-7/16	7-5/8	3-25/32	2-1/4	8-1/2	3-1/4	8-13/16	82
2-1/4-2-3/8	21-5/8	2-7/8	8-1/2	4-9/32	2-1/2	9	3-5/8	9-3/4	103-1/2
2-1/2-2-5/8	23-1/2	3-1/8	9-1/2	4-25-32	2-7/8	9-3/4	4	10-5/8	143-1/2
2-3/4-2-7/8	25-1/2	5-1/2	10-3/4	5-1/2	3-3/16	11	4-7/8	11-5/8	226
3-3-1/8	27	3-1/4	11-1/2	6	3-5/8	12	5-1/4	11-3/4	259
3-1/2-3-5/8	31	4	13	6-3/4	3-7/8	14	6-1/4	13	415
3-3/4-4	33-1/4	4-1/4	14-1/4	7-1/4	4-1/4	15	7	14	540



LB-305

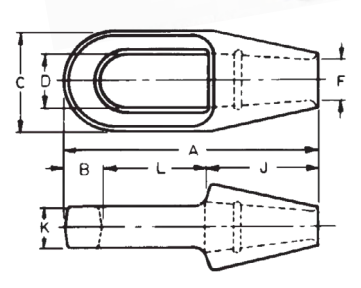

Dimensions are in accordance with Standard Foundry Practice.

Caution: When attaching spelter sockets to wire rope, it is important to follow standard procedures as described by the Wire Rope Technical Board. Brooming and cleaning of wire rope is important. When resin is used, follow manufacturer's assembly instructions.



DCL MOORING & RIGGING

4400 North Galvez Street, New Orleans, LA 70117, U.S.A.
 Tel: +1-504-944-3366 • Toll Free: 1-800-228-7660 • Fax: +1-504-947-8557
 Email: sales@dcl-usa.com
 www.dcl-usa.com